

# Baron



## Features

- Double ball bearing raceways
- Octagon washer on threaded stem for easy installation
- 2" model is heat treated

## Applications

- Store Fixtures
- Furniture
- Office Equipment
- Medical Equipment

## Options

- RoHS compliant zinc finish available by special order; please consult factory for details.

## Wheel Selection

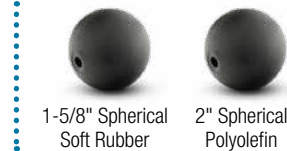

1-5/8" Spherical Soft Rubber

2" Spherical Polyolefin

Wheel Diameter (Inches)	Mounting Height (Inches)	Swivel Radius (Inches)	Tread Material	Finish Type	Dynamic Load (Pounds)	Base Model # (Add fastening code)	Fastening Selection*
1-5/8"	2-5/16"	1-3/4"	Spherical Soft Rubber	Metalized Brass	70	PBH16...MB-3RD	<b>Threaded: 532, 507</b> <b>Grip Neck: 302</b>
				Windsor Antique	70	PBH16...WA-3RD	<b>Grip Ring: 223, 211</b> <b>Plate: 113</b>
2"	2-5/8"	2-1/4"	Spherical Polyolefin	Bright Chrome	80	PBH20...BC-3ED	<b>Threaded: 532, 507, 634, 605</b>
				Metalized Brass	80	PBH20...MB-3ED	<b>Grip Neck: 302</b>
				Windsor Antique	80	PBH20...WA-3ED	<b>Grip Ring: 222, 223, 211</b> <b>Plate: 113</b>

\*To order, include blue fastener code in Base Model Number. Example: PBH16507MB-3RD

## Threaded

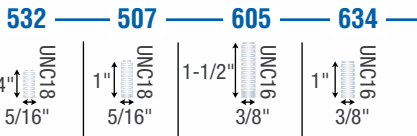

## Grip Neck

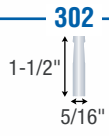

## Grip Ring

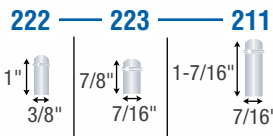

## Top Plate

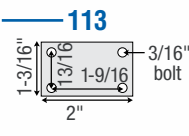

## Finish Options



Metalized Brass



Windsor Antique



Bright Chrome

## Socket Options

Shepherd has many solutions to help you mount your casters to your equipment quickly and easily. See pages 56-57 for more information.



Connects casters to wood



Connects casters to round tubes



Connect casters to PVC pipe legs



Weldable caster mount



Connects casters to square tubes



Corner brackets